

Vertical Lead Sheave Dimensions
Ø10" Without Limit Switch

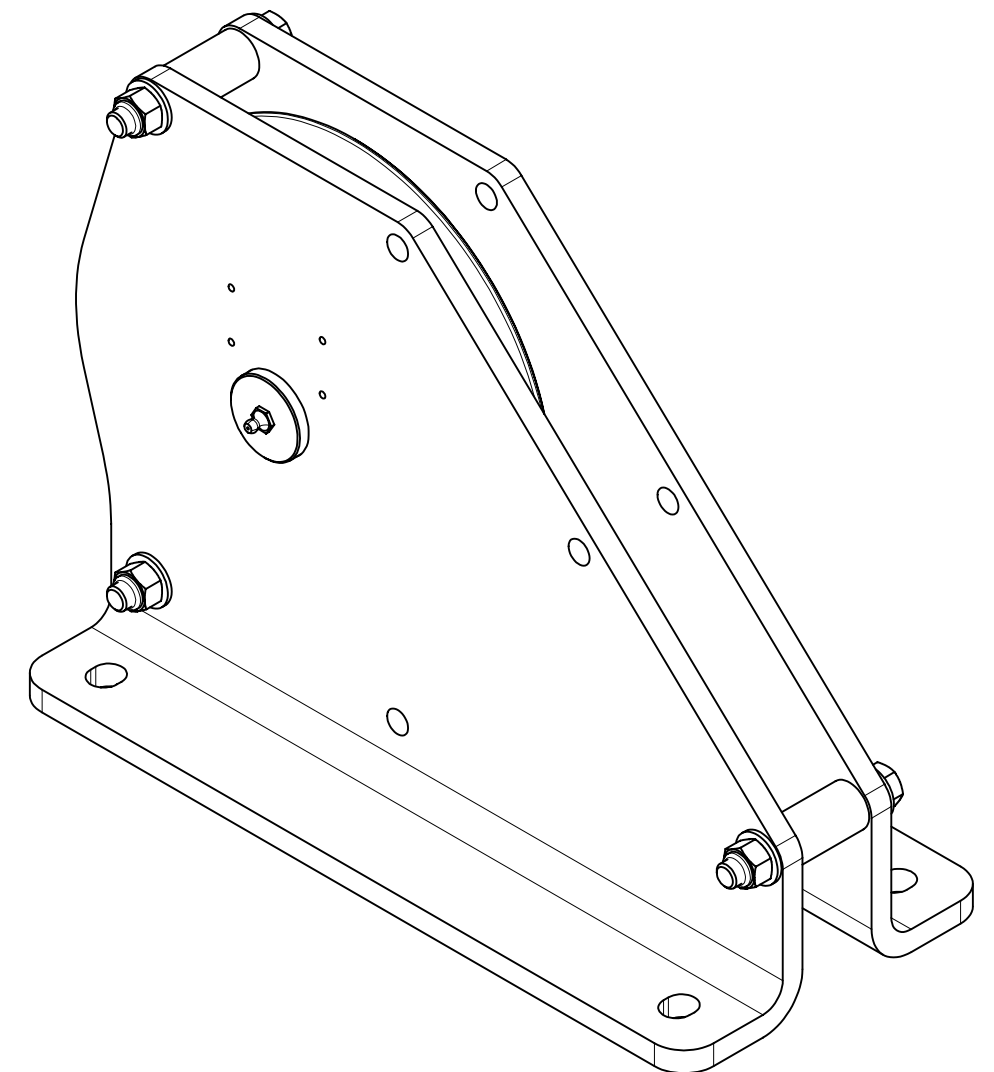
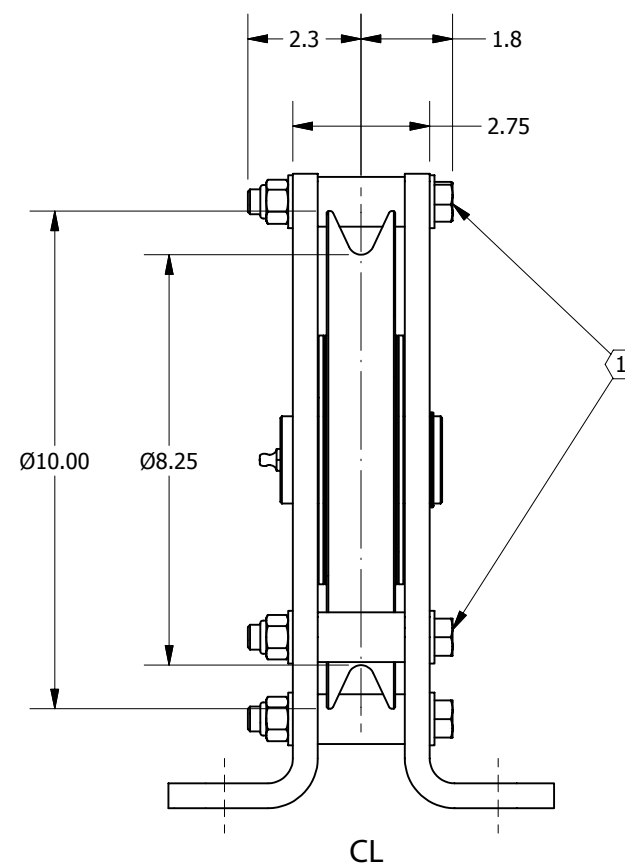
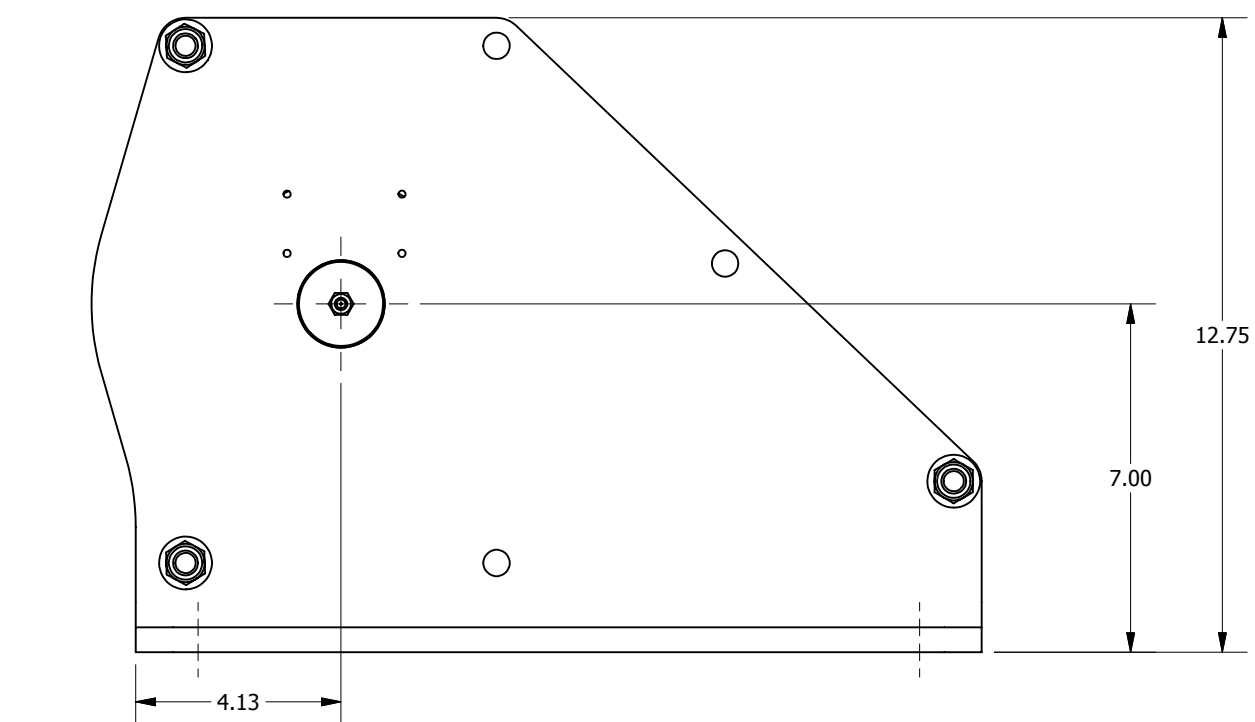
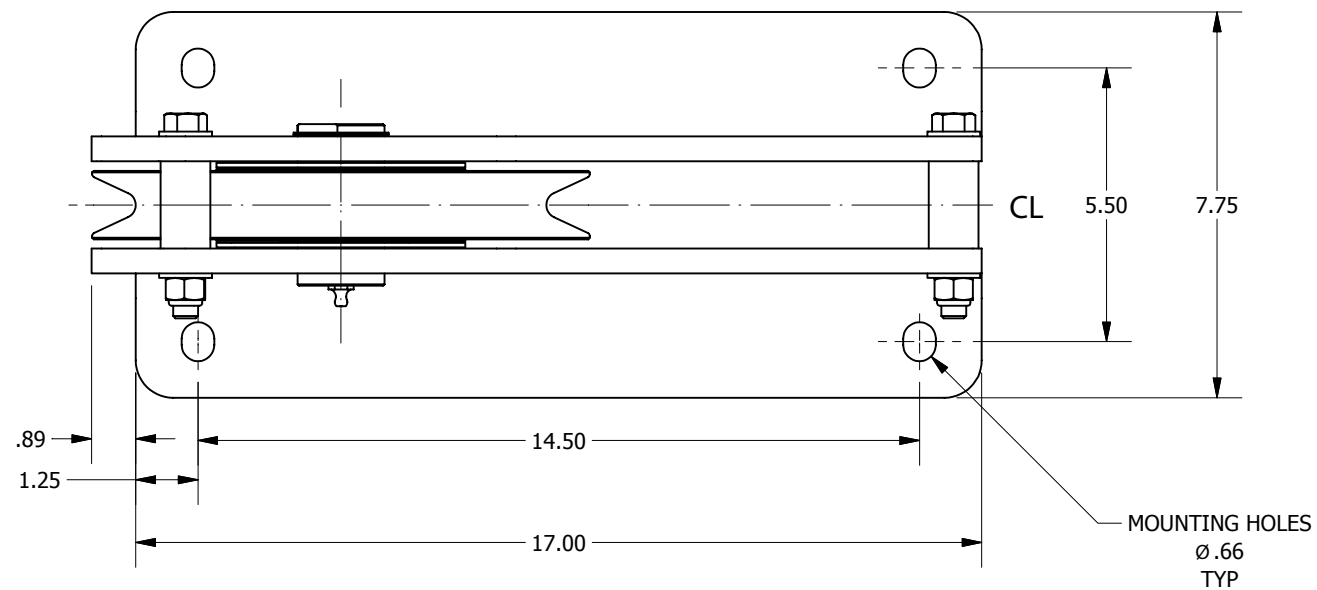

NOTE:

- 1 SIX LOCATIONS ARE PROVIDED FOR BOLT & SPACERS, MOVE AS NECESSARY TO CLEAR LINE. BOLT & SPACERS TO FORM LARGEST TRIANGLE PATTERN FEASIBLE.
- 2 SHEAVE IS SUITABLE FOR USE WITH Ø1/2" OR Ø7/16" WIRE OR SYNTHETIC ROPE.

This print is the property of Allied Power Products, Inc. and may not be used in any manner detrimental to their interest.